

BZE24EZ

24 VDC Roller Belt Conveyor (Zero Pressure Accumulating Type)

The model BZE24EZ Accumulating conveyor uses a series of 24VDC motors to drive full width belt over roller zones. Quiet operation, zero pressure accumulation and reduced belt friction are some of the advantages.

- EZLogic[®] Accumulation System
- All-Electric Operation
- Adjustable MS-Type Floor Supports Available
- Direct Drive Roller
- Pop-Out Roller



Conveyor shown with optional floor supports



EZLOGIC

U.S. Patent Numbers
5,862,907 • 7,243,781
7,591,366 • 7,905,345
6,860,381 • 9,714,142
Other Patents Pending.

Section Length	Between Rail Width	15"	21"	27"	33"
	Belt Width	14"	20"	26"	32"
	Overall Frame Width	19-1/4"	25-1/4"	31-1/4"	37-1/4"
10'-0"	Weights (lbs.)	388	428	468	508
Per Foot	Weights (lbs.)	27	31	35	39

Note: Bed Sections available in the following multiples:
24" Zones—2, 4, 6, 8 & 10, 30" Zones—2 1/2, 5, 7 1/2 & 10, 36" Zones—3, 6, 9'

POWER SUPPLY CHART

STANDARD MOTOR WITH CARD (033.0905)

	NUMBER OF DRIVES	AMPS	VOLTAGE
EB-000003	1-6	20	115VAC
EB-000004	1-12	40	115VAC
EB-000005	1-6	20	460VAC
EB-000006	1-12	40	460VAC
EB-000007	1	5	115VAC
EB-000007	1	5	460VAC

125 WATT MOTOR WITH CARD (033.0905)

	NUMBER OF DRIVES	AMPS	VOLTAGE
EB-000003	1-5	20	115VAC
EB-000004	1-10	40	115VAC
EB-000005	1-5	20	460VAC
EB-000006	1-10	40	460VAC
EB-000007	1	5	115VAC
EB-000007	1	5	460VAC

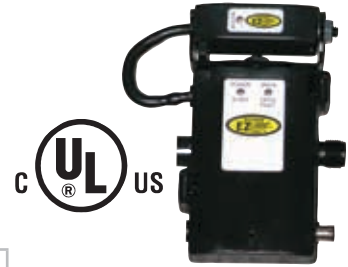

HOW IT WORKS

The conveyor is divided into accumulation zones. Each zone is powered by a 24 VDC Motor. The motor may be turned off to cause product in that zone to stop. Hytrol's EZLogic[®] Zone Controllers sense product presence and control the accumulation and release of product from the zones.

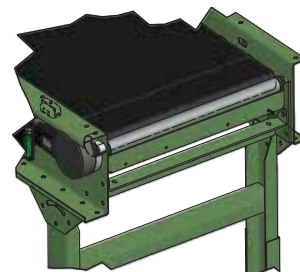
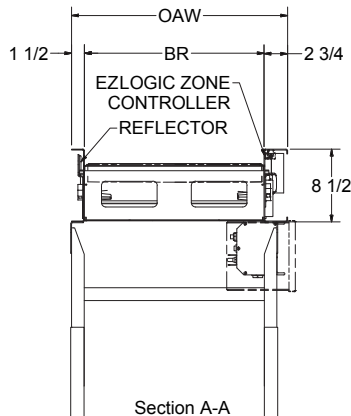
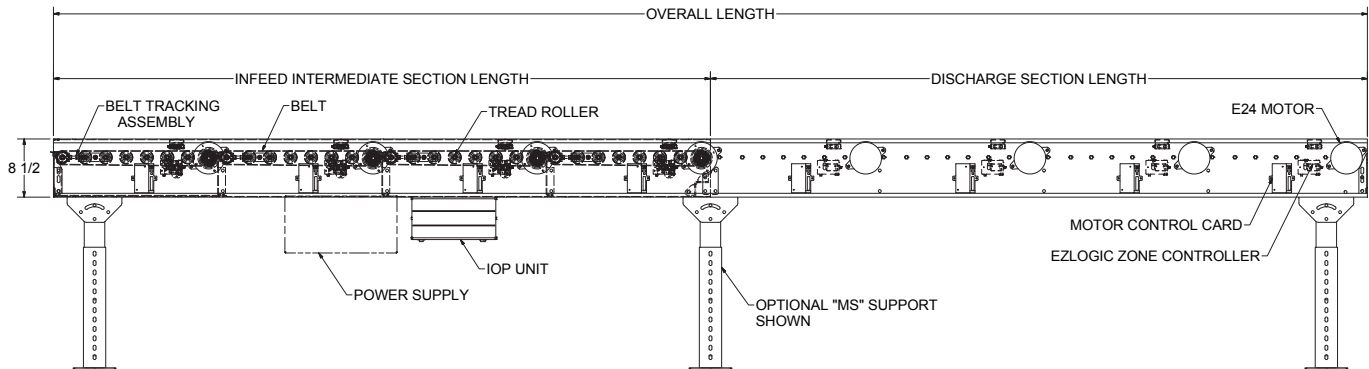

POP-OUT ROLLER ASSEMBLY LOCATED AT DISCHARGE END



• STANDARD SPECIFICATIONS

BED—Roller bed with 1.9 in. dia. roller x 16 ga. galvanized rollers spaced every 3 in. Mounted in 8 ½ in x 12 ga. powder painted formed steel channel frame bolted together with splice plates.

DRIVE ROLLER—1.9 in Dia. Fully Lagged with Trapezoidal Crown.

BELT—PVC, Endless splice.

MOTOR—24 VDC, 100W motor. One in each zone of conveyor mounted on outside coupled directly to a lagged drive roller.

MOTOR CONTROL CARD—Used with each 24VDC Motor utilizing the 3A setting mounted on outside frame.

ACCUMULATION ZONES—24 in., 30 in., and 36 in. zones available.

SET LOW CHANNEL— Added additional flanges to make the installation and removal of the optional cover simple.

EZLogic[®] ZONE CONTROLLER — Located in each zone. (Retro-reflective). NEMA 1, 2, IP 62. UL Approved.

POWER SUPPLY (FOR MOTORS)—40 amp DC power supply, 24 volt fixed output. Maximum of 12 zones per power supply. 120 vac, 4.56 amp input. Mounted near center of conveyor.

IOP—Provides 27VDC, 100 watt power for EZLogic[®] accumulation system - contains slots for 4 input/output boards. Operates up to 50 zones with maximum of 25 on either side of IOP. Requires 120VAC or 230VAC single phase input.

CONVEYING SPEED—See below for speed chart.

CAPACITY—Maximum load 37 lbs. per foot, 75 lbs. per zone at 65 FPM.

FLOOR SUPPORTS—Now supplied as optional equipment.

SPEED CHART							
Switches				100W24		125W24	
SW2-1	SW-2	SW-3	SW-4	033.0905 Standard Card		033.0905 Standard Card	
				RPM	FPM	RPM	FPM
OFF	OFF	OFF	OFF	280	161	350	201
ON	OFF	OFF	OFF	265	152	331	190
OFF	ON	OFF	OFF	250	144	312	179
ON	ON	OFF	OFF	235	135	293	168
OFF	OFF	ON	OFF	220	126	274	157
ON	OFF	ON	OFF	205	118	255	147
OFF	ON	ON	OFF	190	109	236	136
ON	ON	ON	OFF	175	101	217	125
OFF	OFF	OFF	ON	160	92	198	114
ON	OFF	OFF	ON	145	83	179	103
OFF	ON	OFF	ON	130	75	160	92
ON	ON	OFF	ON	115	66	141	81
OFF	OFF	ON	ON	100	57	122	70
ON	OFF	ON	ON	85	49	103	59
OFF	ON	ON	ON	70	40	84	48
ON	ON	ON	ON	55	32	65	37

EZLOGIC[®] ACCUMULATION SYSTEM

Hytrol's EZLogic[®], or "Electronic Zero-pressure Logic" Accumulation System, combines the sensing accuracy of photo-electronics with discrete electronic logic control without the use of a PLC or pneumatic logic components. The EZLogic[®] Accumulation System provides many features including:

Zero-Pressure Accumulation of Product

Zone Stop function is built in. Any zone may be transformed into a workstation by connecting a dry contact switching device to the auxiliary port of the EZLogic[®] Zone Controller. This feature is always used at the discharge end of the conveyor line, and may be used at any other location where a zone stop is required.

Selectable Modes of Operation

Singulation Mode – Product separates while traveling down the conveyor and when it is released from the conveyor - creating a zone-length gap between products.

Enhanced Slug Mode w/ Jam Protection – Product does not separate when traveling down the conveyor or when it is released from the conveyor. This allows higher product throughput at any given conveyor speed. Product will not separate on the conveyor even when accumulation has been activated at the discharge end.

Cascaded Slug Release – Rather than releasing all zones simultaneously, this function introduces a momentary delay in the release of each zone, from discharge upstream.

Dynamic Zone Allocation – Automatically adjusts the conveyor's zone length to accommodate the length of the product being conveyed. Improves conveyor efficiency and system flexibility.

• OPTIONAL EQUIPMENT

FLOOR SUPPORTS—MS Type floor supports are available with a wide range of adjustment. Specify top of belt or roller elevation. One support required at every bed joint and ends of conveyor. Holes in feet for lagging to floor. Knee braces recommended above MS-6 support.

MOTOR AND CONTROL CARD—Provides speed range of 40-190 FPM. 125 Volt motor at 4A setting on standard card.

POWER SUPPLY (FOR MOTORS)—20 amp power supply available. 6 zones maximum. 120 volt @ 4.56 amps.

POWER SUPPLY (FOR MOTORS)—460 volt, 3 phase – 20 and 40 amp available.

POLY-TIER SUPPORTS—36 in. to 120 in. support heights in 6 in. increments. Knee braces required.

CEILING HANGERS—½ in. dia. x 8 ft. long unplated steel rods fully threaded. Other lengths and galvanized rods available.

EZLogic[®] – See EZLogic[®] Components Page.

BRAKE MOTORS—100W motor with 24VDC brake. Provide 24VDC to release brake. Connects to standard card.

